

# Fletcher Insulation

Building Better, Together



For a quieter, more  
comfortable home,  
**insist on Pink® Soundbreak™.**

**PINK**  
**soundbreak**  
acoustic insulation



*Turn down the volume  
between, different  
rooms and even  
different storeys.*

# Ah, that's better... The peace & comfort of **Pink® Soundbreak™**.

**Pink® Soundbreak™** from **Fletcher Insulation** has all the thermal insulating properties of **Pink® Batts** plus amazing acoustic insulation properties. When you choose **Pink® Soundbreak™** for your next home build or renovation, your new home will be energy and thermal efficient **and** extra quiet too.

A quieter home is a happier home. The more you can dampen noise between rooms, the more inviting your home becomes.

Revolutionary **Pink® Soundbreak™** acoustic insulation is designed to help screen out the noise from external sources like busy roads and turn down the volume internally between rooms and between upper and lower storeys, to create a beautifully welcoming ambience that is stress free for any home.





## Fletcher Insulation.

### Building better together.

With a history dating back over half a century, **Fletcher Insulation** is your trusted partner for insulation. **Fletcher Insulation** provides energy efficient and acoustic solutions to the residential, commercial and industrial markets.

**Fletcher Insulation** manufactures and distributes a leading range of insulation brands Australians love and trust. **Pink® Batts** and **Sisalation®** are undoubtedly two of the most common brands that come to mind when you think insulation. That is because our **Pink® Batts** and **Sisalation®** products along with our other leading brands including **Pink® Soundbreak™**, continuously deliver exceptional value to Australians.

Whether you are building or renovating, **Fletcher Insulation** products offer you the perfect opportunity to add value to your home while ensuring that your family has the very best, most comfortable living environment.

# Modern life produces loads of **extra noise.**

There is a whole load of reasons why noise, in all its forms, continues to grow around our homes today.



External noise can be generated by so many factors: passing road traffic, overhead air traffic, noisy neighbours, car alarms going off, burglar alarms, pool pumps, the list goes on...

Interior noise can come from washing machines, vacuum cleaners, dishwashers, blenders, toilets, home theatre systems and so much more.

This high level of noise - inside and out - has all sorts of unwelcome implications for family life which can include poor sleep, homework being missed, unnecessary stress and general home discomfort.

*Now you can  
create a quieter,  
more peaceful  
home environment.*





## **Pink® Soundbreak™:**

Turning down all the noise.

**Pink® Soundbreak™** has been purpose designed to significantly reduce intrusive noise transfer... cutting down noise transfer between rooms and between floors, and from noise entering the home, creating a quieter more peaceful home environment.

A place where family life can thrive, undisturbed.

This is what makes installing **Pink® Soundbreak™** when you build or renovate such a good investment.



# Invest in your new home or renovation.

The decision to include **Pink® Soundbreak™** in interior walls during construction phase, really pays off, whether you're building a new home or renovating.

You can look forward to a noticeable reduction in all types of household noise, along with thermal benefits of being cooler in summer and warmer in winter. Plus, with quality insulation throughout your home, not only are you maximising your overall build quality, you also have the potential of a higher resale value too.

Who needs the sounds of loud noises, when you can have the peace, quiet and thermal comfort only **Pink® Soundbreak™** provides?





Don't worry, **Pink®**  
**Soundbreak™**  
have you covered  
no matter where  
you live...



# So how does **Pink® Soundbreak™** work?

Installed in the timber stud cavity in a partition wall, **Pink® Soundbreak™** provides a dense layer of insulation which absorbs and directs the noise that travels from one room to another. It **won't** sound proof a room but it will significantly reduce the impact of loud noises. In a standard partition wall, **it can reduce noise levels by up to 10 decibels** compared to a non-insulated partition wall. That means no more toilets flushing in the night or other extraneous noise, disturbing the rest of the family. It's better year round comfort for you and your family.

**Pink® Soundbreak™** also contains first class thermal properties that work to keep warm air inside your home during winter plus keep it cool during our long Australian summers.

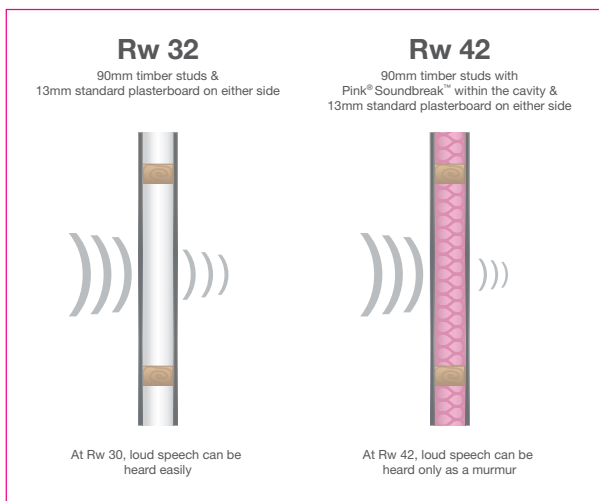

*Rw is the weighted sound reduction in dB and it describes the airborne sound insulating power of a building element.*

*To put this into context further, consider the following:*

- At Rw 25, normal speech can be heard easily
- At Rw 30, loud speech can be heard easily
- At Rw 35, loud speech can be heard but not understood
- At Rw 42, loud speech can be heard only as a murmur

*Source: USG Boral Systems+ April 2015.*

## Stop exterior noise disturbing your home life.

Your home is your sanctuary. It's where you unwind at the end of long hard days.

By including **Pink® Soundbreak™** in your external walls... all that noise from next door's pool pump, passing traffic or planes flying overhead, can largely be a thing of the past.



## Install **Pink® Soundbreak™** between floors.

At construction stage, it is wise not to make the mistake of overlooking insulating **between the floors of your home.**

Noise can transfer from upstairs to downstairs at an alarming rate:

no one wants to hear a family member moving around upstairs.



However, by including **Pink® Soundbreak™** in the internal ground floor ceiling, airborne noise will be largely absorbed, greatly reducing the transmission of structural noise within your home.

And as a great added bonus, your home will be **warmer in winter and cooler in summer** due to the renowned thermal qualities of **Pink® Soundbreak™**.



## The **Pink® Soundbreak™** Homeowner **Lifetime Warranty.**

It's priceless peace of mind knowing you're living with Australia's favourite insulation material backed by the reassurance of the **Pink® Soundbreak™ Lifetime Warranty.**



Now, provided your **Pink® Soundbreak™** wall and ceiling products are installed correctly, you will enjoy high quality insulation for the lifetime of your home. Guaranteed\*.

**Visit [www.insulation.com.au](http://www.insulation.com.au)** for details.

\*If installed as per manufacturers guidelines.

# Living best of all with **Pink® Soundbreak™**.

If creating the ultimate well insulated and quiet environment is the priority, this is the insulation package we recommend. Specifying **Pink® Soundbreak™** right throughout the job - around all external walls + around noisy rooms and all internal walls + in between floors of a 2-storey home. Now you can look forward to all the peace and quiet in the world... cooler in summer and warmer in winter.

**Pink® Soundbreak™ installed around the external walls, internal walls, noisy rooms and in between floors.**



*Creating the ultimate home sanctuary.*

# Living better with **Pink® Batts** + **Pink® Soundbreak™**.

If turning down the noise between areas and rooms in your new home is important, we suggest this combination of Fletcher Insulation products...

Installing **Pink® Batts** in your ceilings and external walls at construction stage + insisting on the superior acoustic qualities of **Pink® Soundbreak™** around noisy rooms. That way, you'll be cooler in summer, warmer in winter... and enjoying a lovely relaxed, far less noisy lifestyle at home, day and night. Now the sound of toilets flushing in the night or loud home theatre sound disturbing the rest of the family will be a thing of the past.

**Pink® Batts** installed around the **external walls** and **Pink® Soundbreak™** around the **noisy rooms**.

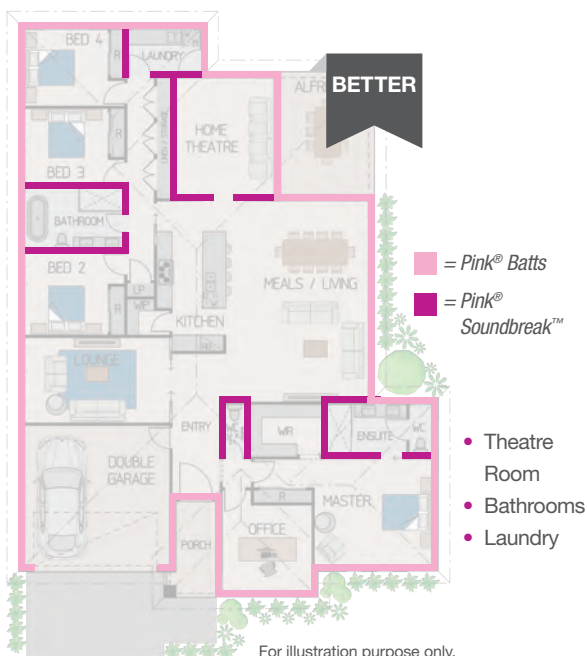

*Exceeding standard Australian Building Code requirements.*

# Living well with **Pink® Batts.**

**Fortunately, even if your budget is tight,** installing Fletcher Insulation's renowned **Pink® Batts** in your ceilings and external walls at construction stage will provide cost effective and council-compliant insulation... Keeping you and the family cooler in summer and warmer in winter. Guaranteed\*.

\*If installed as per manufacturers guidelines.

## **Pink® Batts installed around the external walls.**

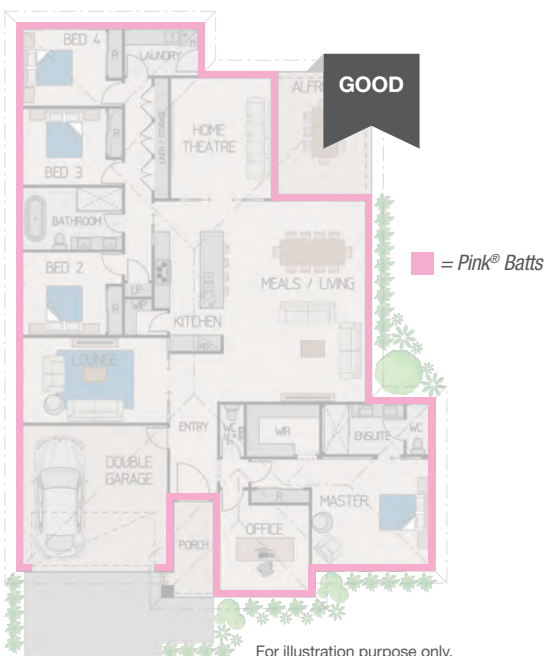

*Meeting standard Australian Building Code requirements.*



# Fletcher Insulation Approved Installer.



## Pink® Soundbreak™

should be installed with the same amount of love that goes into their manufacture by **Fletcher Insulation**. After all, any rogue gaps or spaces can allow warm or cool



air to escape or infiltrate. And the result? Your **Pink® Soundbreak™** can't do their job properly and you won't get the most out of your smart investment.

Naturally that's the last thing you, or we as proud manufacturers, want. Which is why we're strongly recommending you get a **Fletcher Insulation Approved Installer** on the job.

## Pink® Soundbreak™ Specifications.

	Material R-value	Product Code	Nominal Thickness (mm)	Product Dimensions (mm)	Batts per pack	m² per pack	Coverage per pack (m²)
Wall	R1.7	902191	60	1160 x 430	12	6.0	6.9
		902192		1160 x 580	12	8.1	9.1
	R2.0	902193	70	1160 x 430	10	5.0	5.6
		902194		1160 x 580	10	6.7	7.6
		902195		1200 x 600	10	7.2	7.2
	R2.5	902196	90	1160 x 430	8	4.0	4.5
		902197		1160 x 580	8	5.4	6.1
	R2.7	902198	90	1160 x 430	8	4.0	4.5
		902199		1160 x 580	8	5.4	6.1
		902200		1200 x 600	8	5.8	5.8
	R3.1	902201	110	1160 x 430	6	3.0	3.4
		902202		1160 x 580	6	4.0	4.5



# Fletcher Insulation

**Building Better, Together**

Customer Service Phone

**1300 654 444**

Email [info@insulation.com.au](mailto:info@insulation.com.au)

**[www.insulation.com.au](http://www.insulation.com.au)**

©Fletcher Insulation Pty Limited 2016. The colour PINK, Pink® and Pink Batts® are registered trademarks of Owens Corning used under licence by Fletcher Insulation. FBS-1 Glasswool Bio-Soluble Insulation® is a registered trademark of ICANZ. Unless otherwise stated all other™ and ® are trademarks or registered trademarks of Fletcher Insulation Pty Limited ABN 72 001 175 355. BR015\_Revision\_0\_Issue Date 010318