

FOILBOARD® INSULATION SYSTEMS

INSTALLATION GUIDE

To achieve maximum thermal performance and to ensure fast and simple installation of Foilboard® GREEN rigid insulation panel to concrete suspended slab, Foilboard Australia recommends the following method.

What do you need?



Use Foilboard® Standard Fasteners for GREEN 10 and GREEN 15 OR Foilboard® Ultra Fasteners for GREEN 20 and GREEN 25 (Use Timber or Steel fasteners depending on batten material)



Foilboard® Green or Sliver Joining tape

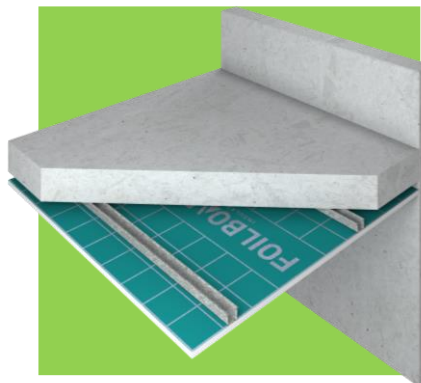

SUSPENDED SLAB

How to Install?



Foilboard GREEN rigid insulation panel should be installed to the internal face of the concrete or batten, with the anti glare side facing out. Measure the area you require

STEP 1

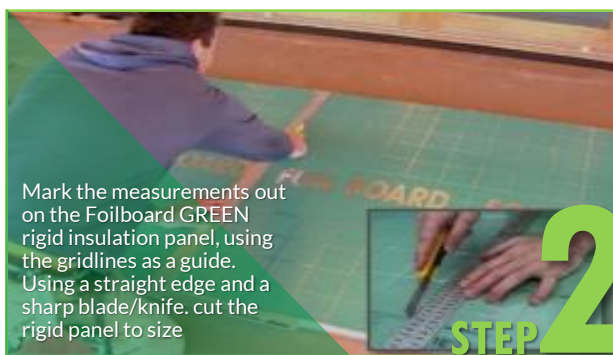

Mark the measurements out on the Foilboard GREEN rigid insulation panel, using the gridlines as a guide. Using a straight edge and a sharp blade/knife, cut the rigid panel to size

STEP 2



Pictured - Generic insulation fastener

Install full sheets to concrete floor with mechanical fasteners. Foilboard can be installed directly to the concrete or fixed to a batten

STEP 3

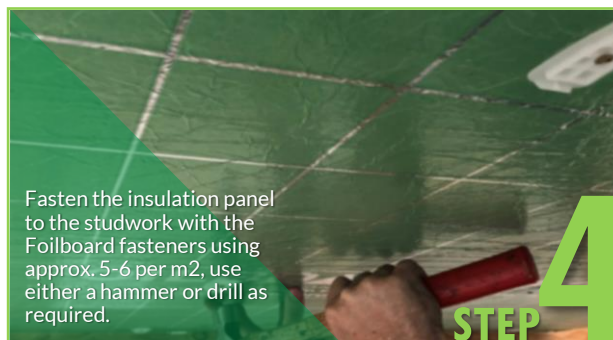

Fasten the insulation panel to the studwork with the Foilboard fasteners using approx. 5-6 per m2, use either a hammer or drill as required.

STEP 4

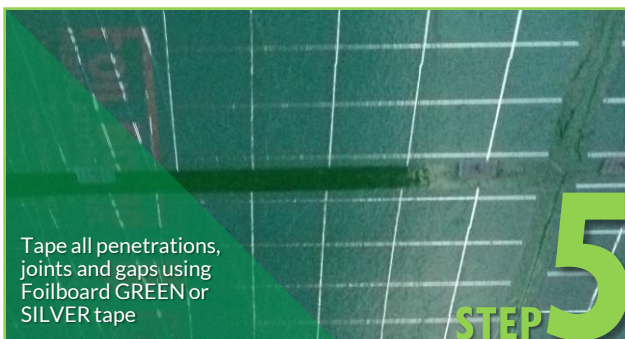

Tape all penetrations, joints and gaps using Foilboard GREEN or SILVER tape

STEP 5

- ✓ Batten fixing will increase the thermal performance of the insulation by creating an airspace.
- ✓ Save time by starting with areas that can accommodate the full sheets.
- ✓ The Foilboard® GREEN antiglare is there to protect you. Both the antiglare and silver foil reflect heat.

TOP TIPS



It's the smarter way to insulate

INFORMATION HOTLINE: 1800 354 717
www.foilboard.com.au